



# TURNSTILES CATALOGUE

MOTOR ASSISTED TURNSTILES  
ELECTROMECHANICAL TURNSTILES  
HIGH SECURITY TURNSTILES  
MECHANICAL TURNSTILES

**CAME** 

[CAME.COM/UK](http://CAME.COM/UK)





**CAME** 

# GENERAL INDEX AND LEGEND OF SYMBOLS



Gearmotor or operator  
with ENCODER



The 24 or 36 V DC  
turnstiles are designed for  
INTENSIVE DUTY and are  
guaranteed to work even  
during power outages.  
This icon also means that  
a product is powered by  
low voltage.



This product can be  
remotely controlled via  
CAME Connect cloud  
technology

## TURNSTILES



Motor assisted tripod turnstiles



Motor assisted tripod turnstiles



Electromechanical tripod turnstiles



Electromechanical tripod turnstiles



Motor assisted tripod turnstiles



High security turnstiles



Motor assisted swing turnstiles



Motor assisted swing turnstiles



Mechanical turnstiles



Mechanical swing turnstiles



# STILE ONE

Motor assisted tripod turnstiles

## Compact tripod-turnstile, convenient when space is an issue

- The structure is made of varnished steel, whereas the tripod arms are made of AISI 304 stainless steel.
- You can program and control Stile One through your access-control system, or, remotely through the CRP (Came Remote Protocol).
- The encoder detects any tampering attempts and a standard beeper issues the alert.
- During power outages, the tripod releases, so people can pass through in either direction available with on the 001PSMM01. The fall-away arm system, available on the 001PSMM02, also activates during blackouts to free up the passage of people.
- You can also fit an optional LED-signaling strip to either of the tripod's sides.
- The built-in control board features its own programming screen; it can be linked up with the RBM84 access-control system, and even with an extra R700 control board that controls the TSP00 and LT001 devices.
- The memory roll enables you to back up settings and memorized users.

## Dimensions (mm)

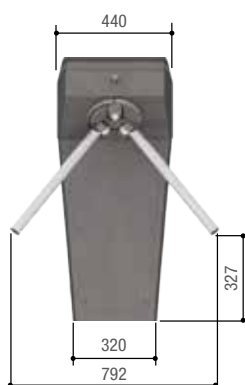

Version with: 001PSMMA-C

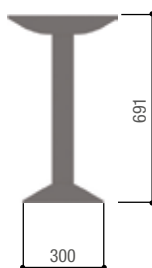
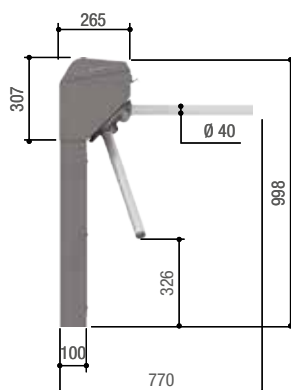

001PSMMA-D

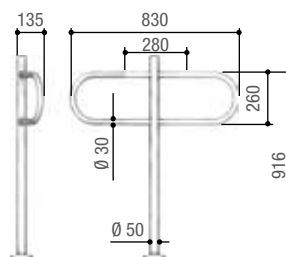
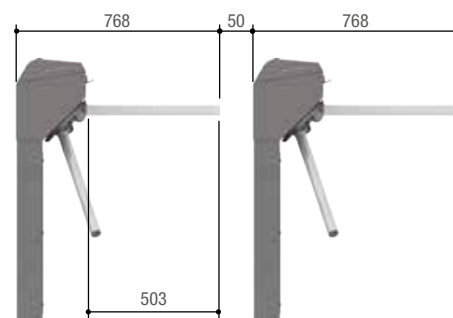

001PSOPGO1X  
001PSOPGO1

## Technical features

MODELS	PSMM01 • PSMM02
Protection rating (IP)	44
Power supply (V - 50/60 Hz)	120 - 230 AC
Consumption in stand-by (W)	4
Weight (kg)	22
Insulation Class	I
Capacity per min*	30
Power (W)	120
Operating temperature (°C)	-20 ÷ +55

\* Detected in free access mode

■ 120 - 230 V AC

Code	Description	Price (Excl. VAT)
<b>Electromechanical tripod turnstiles</b>		
001 <b>PSMM01</b>	Bidirectional motor assisted varnished galvanized-steel turnstile, complete with control board. Tripod automatically releases during power outages.	<b>£1,002.00</b>
001 <b>PSMM02</b>	Bidirectional motor assisted varnished galvanized-steel turnstile, complete with control board and fall-away arm system.	<b>£1,182.00</b>
<b>Accessories for electromechanical tripod turnstiles</b>		
001 <b>PSMMA-A</b>	2 LED Signal bars.	<b>£38.00</b>
001 <b>PSMMA-B</b>	Wall fastening brace kit.	<b>£25.00</b>
001 <b>PSMMA-C</b>	Hollow-core leg.	<b>£198.00</b>
001 <b>PSMMA-D</b>	Tubular leg.	<b>£65.00</b>
<b>Accessories</b>		
001 <b>PSOPG01</b>	Barrier complete with riser with AISI 304 stainless steel arch, galvanized steel anchoring flange and chromed plastic flange cover. H = 1,000 mm.	<b>£162.00</b>
001 <b>PSOPG01X</b>	Barrier made of AISI 304 steel complete with arched riser, fastening flange and flange cover. H = 1,000 mm.	<b>£177.00</b>





### The motor assisted solution, transponder-fitted, for pedestrian access with high traffic.

- Modern sleek design features an outer structure made of AISI 304 stainless steel with key protected access.
- Built-in motor assisted electro mechanical mechanism, pre-rotating for easier access.
- Luminous directional light immediately shows the direction of travel through the tripod so users know where to go.
- Control flow rates from mobile devices the the CAME CONNECT platform.
- AISI 304 stainless steel tripod arm with drop-away and rearm functions (version PSXV02)

### Dimensions (mm)

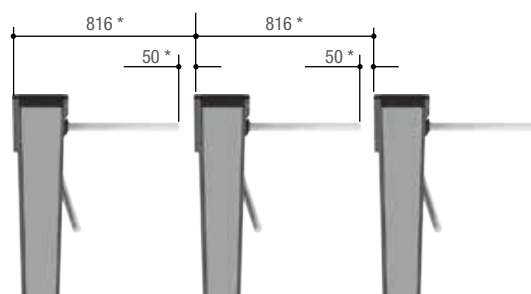
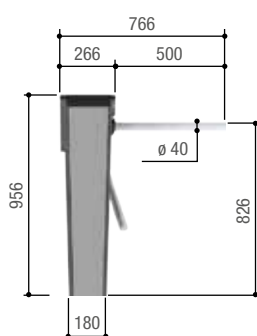
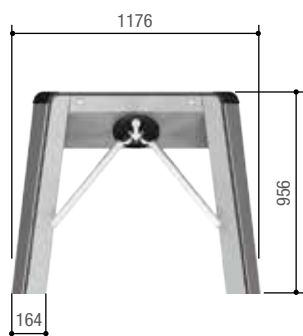

\* Minimum size

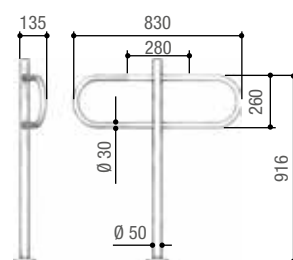

001PSOPGO1X  
001PSOPGO1

### Technical features

MODELS	PSXV02 • PSXV03
Protection rating (IP)	44
Power supply (V - 50/60 Hz)	120 - 230 AC
Consumption in stand-by (W)	18
Weight (kg)	45
Insulation Class	I
Capacity/min*	30
Power (W)	180
Operating temperature (°C)	-20 ÷ +55

\* Detected in free access mode

■ 120 - 230 V AC



Code	Description	Price (Excl. VAT)
<b>Motor assisted bi-directional tripod turnstile</b>		
001PSXV02	Two way bi-directional AISI 304 brushed steel turnstile, complete with control board, LED directional arrows, 5-digit display and automatic tripod release in case of power cuts. Scheduling system on board (or via RFID card if the set 001PSXVA5 or 001PSXVA6 have been installed). <b>Includes drop away and re-arm functions.</b>	£2,090.00
001PSXV03	Two way bi-directional AISI 304 brushed steel turnstile, complete with control board, LED directional arrows, 5-digit display and automatic tripod release in case of power cuts. Scheduling system on board (or via RFID card if the set 001PSXVA5 or 001PSXVA6 have been installed)	£1,894.00
<b>Accessories for bi-directional tripod turnstile</b>		
001PSXVA5	Pair of 125Mhz card readers.	£48.00
001PSXVA6	Pair of MiFare 13.56Mhz readers.	£45.00
<b>Accessories</b>		
001PSOPG01	Barrier complete with riser with AISI 304 stainless steel arch, galvanized steel anchoring flange and chromed plastic flange cover. H = 1,000 mm.	£162.00
001PSOPG01X	Barrier made of AISI 304 steel complete with arched riser, fastening flange and flange cover. H = 1,000 mm.	£177.00

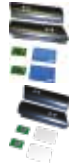

## MULTIFUNCTION DISPLAY AND TRANSPONDER SENSOR

The turnstile comes standard with the multifunction display on both sides and can accommodate the magnetic board antenna (optional) both in the Manchester 125 Khz version and MiFare 13.56 Mhz. Xvia is also equipped with bright LEDs, which are installed on both sides of the tripod.



## MULTIFUNCTION DISPLAY AND TRANSPONDER SENSOR

The 001PSXV02 version features an arm drop function to instantly release the passage in case of an emergency.

# TWISTER LIGHT

Electromechanical tripod turnstiles



## Access control for high flow pedestrian areas, fitted with transponder card control

- Twister light is the innovative turnstile for selecting transit in high flow areas.
- Made from stainless steel, it is ideal for railway stations, ports, underground stations, sporting facilities and anywhere where it is essential to control pedestrian flows, optimising entry and exit operations.
- Twister light is a functional solution, suitable for all transit control and selection requirements.
- Controlled by a built-in control panel, Twister light is perfectly compatible with all the latest access control systems.

## Dimensions (mm)

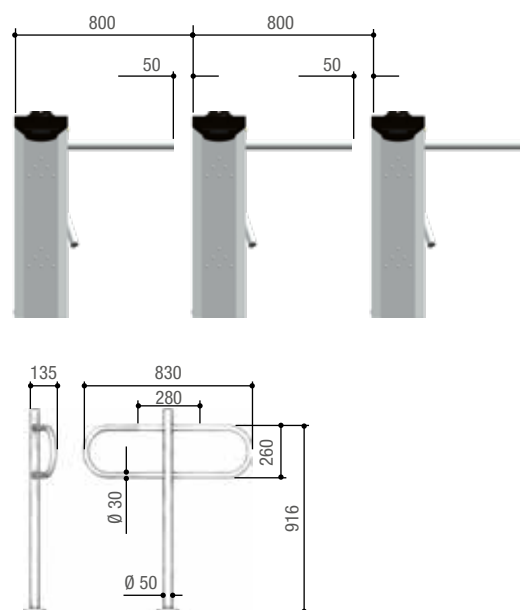
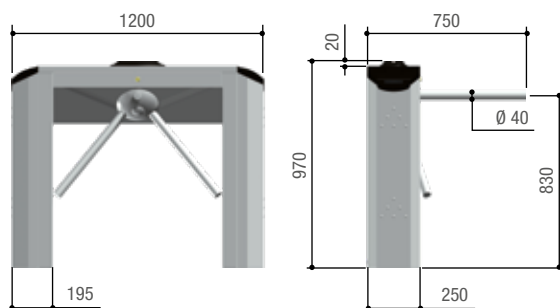

PSOPG01 - PSOPG01X

## Technical features

MODELS	PSBPS07N • PSBPS08 • PSBPS09 • PSBPS10
Protection rating (IP)	44
Power supply (V - 50/60 Hz)	120 - 230 AC
Operating power supply (V)	24 DC
Current draw (mA)	260
Weight (kg)	60
Capacity/min*	12
Operating temperature (°C)	-20 ÷ +55

\* Detected in free access mode

■ 230 V AC

Code	Description	Price (Excl. VAT)
<b>Electromechanical tripod turnstiles</b>		
001PSBPS07N	AISI 304 steel electromechanical bidirectional turnstile with scotch-brite finishing, featuring control board, hydraulic damper and automatic tripod release in case of blackouts.	£1,197.00
001PSBPS08	Electromechanical bidirectional turnstile in AISI 304 steel with scotch-brite finishing, featuring control board, hydraulic damper and automatic tripod release in case of blackouts. <b>Includes high-luminosity LED bidirectional traffic light</b>	£1,216.00
001PSBPS09	Electromechanical bidirectional turnstile in AISI 304 steel with scotch-brite finishing, featuring control board, hydraulic damper, high-luminosity LED bidirectional traffic light and automatic tripod release in case of blackouts. <b>Includes a seismic sensor to prevent climbing over.</b>	£2,012.00
001PSBPS10	AISI 304 steel electromechanical bidirectional turnstile with scotch-brite finishing, featuring control board, hydraulic damper, bidirectional LED traffic light and automatic release of the tripod in case of blackouts. <b>Includes arm fall away system.</b>	£1,946.00
<b>Accessories for electromechanical tripod turnstiles</b>		
001PSOPSC01	Anti-panic arms with pressure joint.	£209.00
001PSOPCN03	Electronic counter.	£131.00
001PSOPSF03	LED traffic light with signalling display.	£87.00
<b>Accessories</b>		
001PSOPG01	AISI 304 steel barrier with post and arc, fixing flange and chrome-plated plastic flange cover. H = 1,000 mm.	£162.00
001PSOPG01X	AISI 304 steel barrier with post and arc, fixing flange and flange cover. H = 1,000 mm.	£177.00



# TWISTER

Electromechanical, tripod turnstiles



## Access control for high flow pedestrian areas, fitted with transponder card control

- Twister is the innovative turnstile for selecting transit in high flow areas.
- Made from stainless steel, it is ideal for railway stations, ports, underground stations, sporting facilities and anywhere where it is essential to control pedestrian flows, optimising entry and exit operations.
- Twister is a functional solution, suitable for all transit control and selection requirements.
- Controlled by a built-in control panel, Twister is perfectly compatible with all the latest access control systems.

## Dimensions (mm)

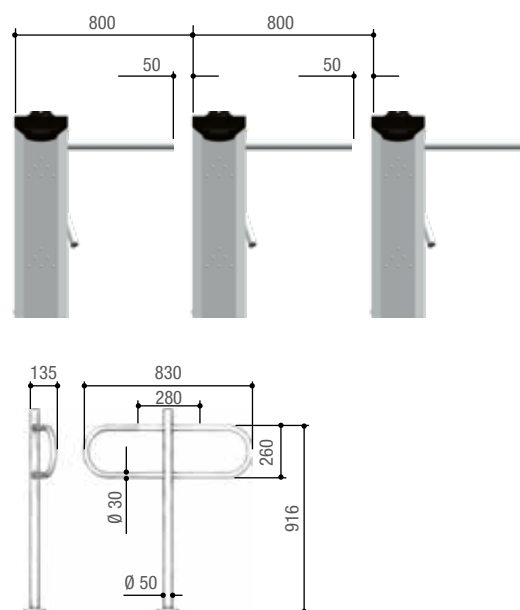
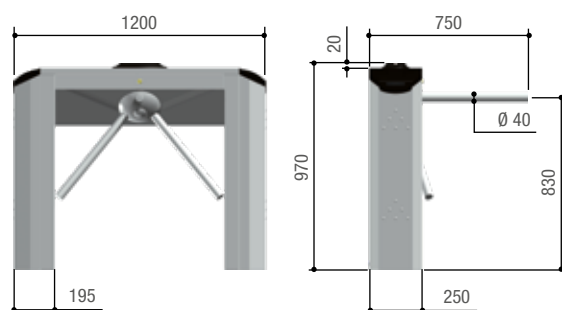

PS0PG01 - PS0PG01X

## Technical features

MODELS	PST01 • PST02 • PST03 • PST04
Protection rating (IP)	44
Power supply (V - 50/60 Hz)	120 - 230 AC
Operating power supply (V)	24 DC
Current draw (mA)	260
Weight (kg)	60
Capacity/min*	12
Operating temperature (°C)	-20 ÷ +55

\* Detected in free access mode

■ 230 V AC

Code	Description	Price (Excl. VAT)
<b>Electromechanical tripod turnstiles</b>		
001PST001	Electromechanical bidirectional turnstile in AISI 304 steel, featuring control board, LED traffic light with signalling display, side traffic lights and hydraulic damper and automatic tripod release in case of blackouts. <b>Includes transponder sensors.</b>	£1,338.00
001PST002	Electromechanical bidirectional turnstile in AISI 304 stainless steel, featuring control board, hydraulic damper and LED traffic light with signalling display. Automatic tripod release in case of blackouts.	£1,271.00
001PST003	Electromechanical bidirectional turnstile in AISI 304 steel, featuring control board, hydraulic damper, high-luminosity LED bidirectional signalling traffic light and automatic tripod release in case of blackouts. <b>Includes a seismic sensor to prevent climbing over.</b>	£2,076.00
001PST004	Electromechanical bidirectional turnstile in AISI 304 steel, featuring control board, hydraulic damper, LED traffic light with signalling display and automatic tripod release in case of blackouts. <b>Includes arm fall away system.</b>	£1,995.00
<b>Accessories for : 001PST001 - 001PST002 - 001PST003</b>		
001PSOPSC01	Anti-panic arms with pressure joint.	£209.00
<b>Accessories for : Electromechanical tripod turnstiles</b>		
<b>821XC-0020</b>	Anti-panic arms with pressure joint.	£499.00
<b>Accessories</b>		
001PSOPG01	AISI 304 steel barrier with post and arc, fixing flange and chrome-plated plastic flange cover. H = 1,000 mm.	£162.00
001PSOPG01X	AISI 304 steel barrier with post and arc, fixing flange and flange cover. H = 1,000 mm.	£177.00



# MOTORISED TWISTER

Motor assisted, tripod turnstiles



## Access control for high flow pedestrian areas, fitted with transponder card control

- Twister is the innovative turnstile for selecting transit in high flow areas.
- Made from stainless steel, it is ideal for railway stations, ports, underground stations, sporting facilities and anywhere where it is essential to control pedestrian flows, optimising entry and exit operations.
- Available with fixed and falling arm versions.
- Motorised Twister has a better duty cycle than electromechanical version.
- The turnstile has been developed for connection to the cloud via CAME Connect.

## Dimensions (mm)

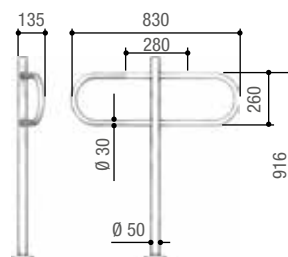
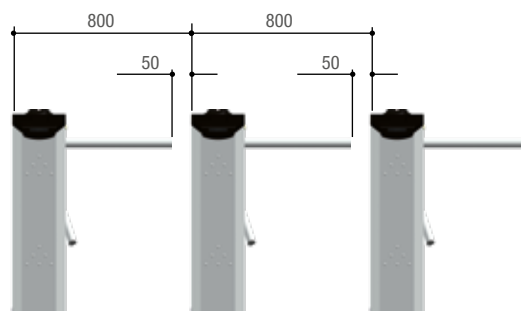
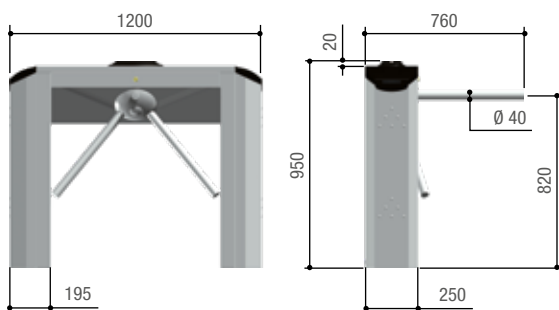



PSOPG01 - PSOPG01X

## Technical features

MODELS	821TR-0010 • 821TR-0020
Protection rating (IP)	44
Power supply (V - 50/60 Hz)	120 - 230 AC
Operating power supply (V)	24 DC
Current draw (mA)	260
Weight (kg)	60
Capacity/min*	30
Operating temperature (°C)	-20 ÷ +55

\* Detected in free access mode

■ 230 V AC

Code	Description	Price (Excl. VAT)
Motor assisted, tripod turnstiles		
<b>821TR-0010</b> 	TWS32MXY - Two-way, satin-finish, AISI 304 stainless steel motor assisted turnstile, featuring a control board, LED signalling-arrows, lateral stop-go lights and break-in alarm. Automatically release during power outages.	<b>£2,026.00</b>
<b>821TR-0020</b> 	TWS32MXZ - Two-way, satin-finish, AISI 304 stainless steel motor assisted turnstile, featuring a control board, LED signalling-arrows and lateral stop-go lights and break-in alarm. <b>Includes automatically-resetting drop-away arm.</b>	<b>£2,420.00</b>
Accessories for : Motor assisted tripod turnstiles		
<b>821XC-0020</b>	Anti-panic arms with pressure joint.	<b>£499.00</b>
Accessories		
001 <b>PSOPG01</b>	AISI 304 steel barrier with post and arc, fixing flange and chrome-plated plastic flange cover. H = 1,000 mm.	<b>£162.00</b>
001 <b>PSOPG01X</b>	AISI 304 steel barrier with post and arc, fixing flange and flange cover. H = 1,000 mm.	<b>£177.00</b>



# Guardian

High security turnstiles



## The high security system for access control in high traffic flow situations

- Guardian is the perfect solution if you need to secure large entrances, even if unmanned, with high pedestrian flows.
- Also designed for outdoor use, Guardian can be used in airports, ports, large companies, underground systems, railway stations and stadiums.
- Guardian is the high performance full height turnstile, perfect for environments where security is an essential requirement.
- Its sturdy structure and pleasing design on one hand make it a powerful deterrent for crime and on the other offer total user protection.
- Durability and reliability are guaranteed, even outdoors, thanks to the galvanised steel body and the special epoxy paint, which makes it resistant even in areas subject to corrosive agents.

### Dimensions (mm)

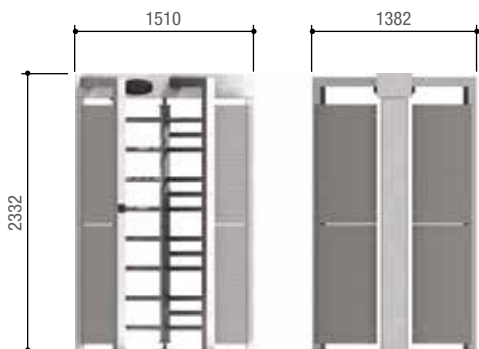

001PSHPS01 - 001PSGS3

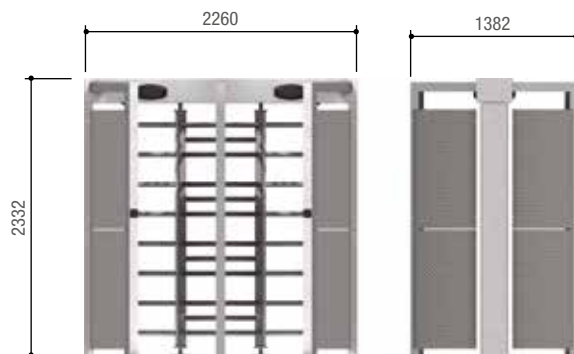

001PSGD3

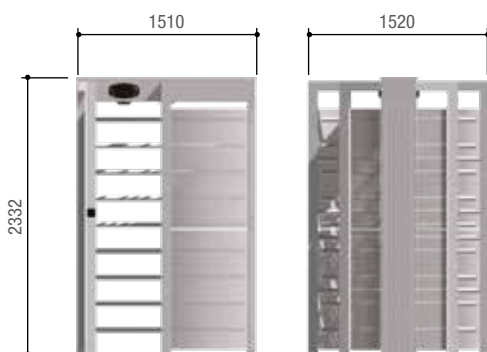

001PSGS4

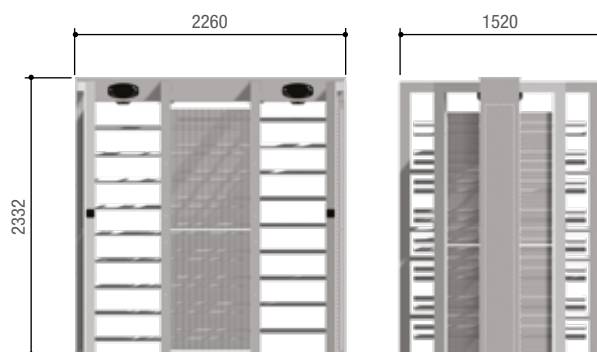

001PSGD4

### Technical features

MODELS	PSHPS01	PSGS3 • PSGS4	PSGD3 • PSGD4
Protection rating (IP)	44	44	44
Power supply (V - 50/60 Hz)	-	120 - 230 AC	120 - 230 AC
Operating power supply (V)	-	24 DC	24 DC
Current draw (mA)	-	223	446
Weight (kg)	400	350	650
Capacity/min*	10	10	10
Operating temperature (°C)	-20 ÷ +55	-20 ÷ +55	-20 ÷ +55

\* Detected in free access mode

■ 230 V AC



Code	Description	Price (Excl. VAT)
<b>Full-height electromechanical turnstiles</b>		
001 <b>PSGS3</b>	Single full-height electromechanical bidirectional turnstile with 3 120° sectors and RAL 7035 painted galvanised structure; it features a control board, a hydraulic damper, high luminosity LED indicators, a multi-function display and a courtesy light.	<b>£5,861.00</b>
001 <b>PSGD3</b>	Double full-height bidirectional electromechanical turnstile, with 3 120° sectors and structure in RAL 7035 painted galvanised steel; it features a control board, a hydraulic damper, high-luminosity LED indicators, multi-function display and courtesy light	<b>£9,812.00</b>
001 <b>PSGS4</b>	Single full-height electromechanical bidirectional turnstile with 4 90° sectors and RAL 7035 painted galvanised structure; it features a control board, a hydraulic damper, high luminosity LED indicators, a multi-function display and a courtesy light.	<b>£6,381.00</b>
001 <b>PSGD4</b>	Double full-height bidirectional electromechanical turnstile, with 4 90° sectors and structure in RAL 7035 painted galvanised steel; it features a control board, a hydraulic damper, high-luminosity LED indicators, multi-function display and courtesy light	<b>£11,652.00</b>
<b>Customised treatments</b>		
001 <b>COLOR16</b>	Extra treatment.	<b>£POA</b>



#### NOTES

Paint treatments are placed upon customer requests.  
Delivery: min 15 working days from receiving the order.



## Fast, elegant opening, with easy and safe installation

- The leaf secured inside the automation makes the lines extremely harmonious and simple.
- Built-in luminous crown, with modular assembly, warns of leaf movement and operating status.
- The control board, the power supply and the electric brake are inside the automation.
- The built-in electric brake blocks the leaf, allowing access to authorised users only.
- The motor with encoder enables easy management of the slowdown and obstacle detection stages.
- The programming and function display screen is located in an easily accessible place.
- Movement activation, via transponder card, magnetic card, buttons or photocells.
- Memory Roll for saving configurations and users.
- AISI 304 steel structure with plexiglas and tempered glass leaf.
- The speed of the leaf can be adjusted directly from the control board.

## Dimensions (mm)

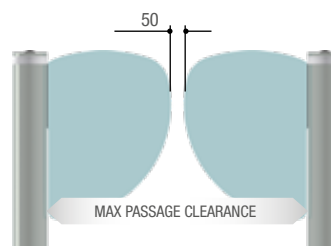
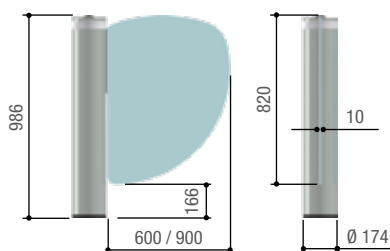

## Operational limits

MODEL	PSWNG40
Min. leaf length (mm)	600 (PSWL60 - PSWL60C)
Max. leaf length (mm)	900 (PSWL90 - PSWL90C)
Min. clearance width (mm)	1250
Max. clearance width (mm)	1850
Max. leaf opening (°)	90

## Technical features

MODEL	PSWNG40
Protection rating (IP)	40
Power supply (V - 50/60 Hz)	120 - 230 AC
Motor power supply (V)	24 DC
Capacity/min*	12
90° opening speed (s)	1
Power (W)	120
Operating temperature (°C)	-20 ÷ +55

\* Detected in free access mode

Code	Description	Price (Excl. VAT)
<b>24 V DC motor assisted swing turnstile</b>		
001 <b>PSWNG40</b> 	Bidirectional motor assisted swing turnstile, in AISI 304 steel, featuring control board and signalling LEDs.	<b>£1,423.00</b>
<b>Accessories</b>		
001 <b>PSWL60</b>	Plexiglass leaf (L = 600 mm, thickness = 10 mm).	<b>£238.00</b>
001 <b>PSWL90</b>	Plexiglass leaf (L = 900 mm, thickness = 10 mm).	<b>£294.00</b>
001 <b>PSWL60C</b>	Glass leaf (L = 600 mm, thickness = 10 mm).	<b>£472.00</b>
001 <b>PSWL90C</b>	Glass leaf (L = 900 mm, thickness = 10 mm).	<b>£473.00</b>
001 <b>PSWLC</b>	Hooking up kit for customized leaf.	<b>£101.00</b>



## RED SIGNALLING LUMINOUS CROWN

It signals that the leaf is closing.

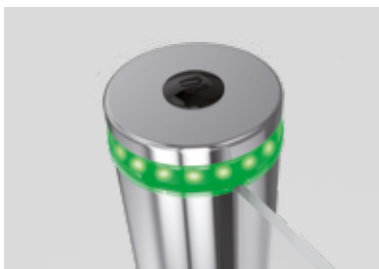

## GREEN SIGNALLING LUMINOUS CROWN

It signals that the leaf is opening.



## BLUE SIGNALLING LUMINOUS CROWN

It signals that the leaf is about to close.



## THE CONTROL BOARD

Featuring a display, built-in to the automation, enabling fast, easy function control.

# SALOON

Motor assisted swing turnstiles



## Fast access, modular, easy and safe installation

- Built-in luminous crown, with modular assembly, warns of leaf movement and operating status.
- Opening always under control, thanks to the acoustic signal that warns of any attempt to force opening.
- The system is reversible so in the event of a blackout, the automation allows manual opening for both entry and exit.
- The motor with encoder enables easy management of the slowdown and obstacle detection stages.
- The programming and function display screen is located in an easily accessible place.
- Movement activation, via transponder card, magnetic card, buttons or photocells.
- Memory Roll for saving configurations and users.
- Easy to install modular barriers.



## Dimensions (mm)

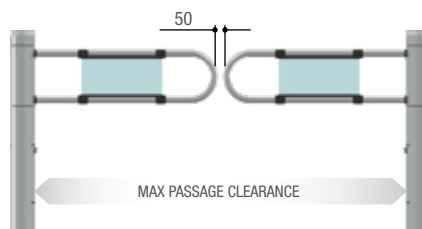
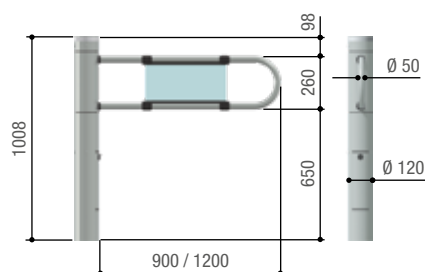

## Operational limits

MODEL	PSSLN40
Min. leaf length (mm)	900 (PSSL90)
Max. leaf length (mm)	1200 (PSSL120)
Min. clearance width (mm)	1850
Max. clearance width (mm)	2450
Max. leaf opening (°)	90

## Technical features

MODEL	PSSLN40
Protection rating (IP)	40
Power supply (V - 50/60 Hz)	120 - 230 AC
Motor power supply (V)	24 DC
Capacity/min*	12
90° opening speed (s)	1
Power (W)	120
Operating temperature (°C)	-20 ÷ +55

\* Detected in free access mode

■ 24 V DC

Code	Description	Price (Excl. VAT)
<b>24 V DC motor assisted swing turnstile</b>		
001 <b>PSSLN40</b> 	Bidirectional motor assisted swing turnstile, in aluminium, featuring control board and signalling LEDs.	<b>£1,030.00</b>
<b>Accessories</b>		
001 <b>PSSL90</b>	Aluminium leaf (L = 900 mm)..	<b>£72.00</b>
001 <b>PSSL120</b>	Aluminium leaf (L = 1,200 mm).	<b>£82.00</b>
001 <b>PSSLC</b>	Customised aluminium leaf. (L = 600 ÷ 1.200 mm).	<b>£89.00</b>
001 <b>PSSA01</b>	Radar for activating the automatic opening.	<b>£158.00</b>
001 <b>PSSA03</b>	Kit of n. 2 chrome-plated plastic sleeves for barrier fixing.	<b>£11.00</b>
001 <b>PSSA04</b>	Kit of n. 2 AISI 304 steel sleeves for barrier fixing.	<b>£40.00</b>

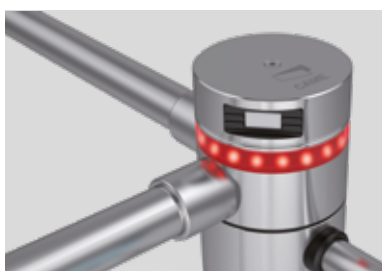
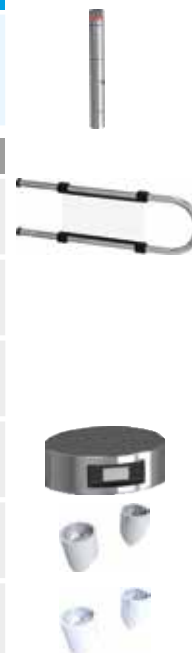

## RED SIGNALLING LUMINOUS CROWN

It signals that the leaf is closing.

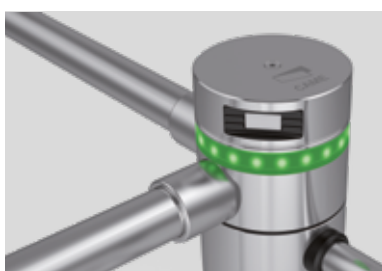

## GREEN SIGNALLING LUMINOUS CROWN

It signals that the leaf is opening.

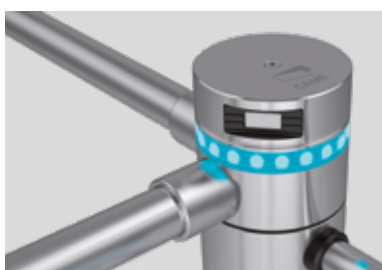

## BLUE SIGNALLING LUMINOUS CROWN

It signals that the leaf is about to close.



## ACTIVATION RADAR

Built-into the automation, it enables the leaf to be opened in advance at a distance.

# COMPASS

Mechanical turnstiles



## The ideal range for controlling pedestrian access

- Compass is the simple, inexpensive solution for guiding flows in an orderly, efficient way in shopping centres swimming pools, gyms and amusements parks.
- Mechanical turnstile with four arms, enabling one person at a time to pass through in both directions.
- The AISI 304 steel structure makes Compass a product suitable for outdoor installations.

## Dimensions (mm)

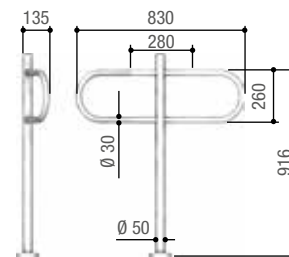
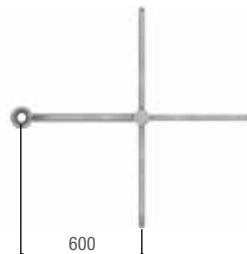
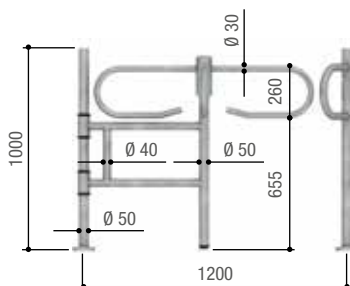

PSOPG01 - PSOPG01X

Code	Description	Price (Excl. VAT)
<b>Mechanical turnstiles</b>		
001 <b>PSSPCWO</b>	Movable mechanical turnstile with right-hand post. To be fixed to the floor.	<b>£735.00</b>
001 <b>PSSPCW</b>	Movable mechanical turnstile with left-hand post. To be fixed to the floor.	<b>£725.00</b>
001 <b>PSSPFMCWO</b>	Fixed mechanical turnstile with right-hand post. To be fixed to the wall.	<b>£710.00</b>
001 <b>PSSPFMCCW</b>	Fixed mechanical turnstile with left-hand post. To be fixed to the wall.	<b>£710.00</b>
<b>Accessories</b>		
001 <b>PSOPG01</b>	AISI 304 steel barrier, galvanised steel fixing flange and chrome-plated plastic flange cover.	<b>£162.00</b>
001 <b>PSOPG01X</b>	AISI 304 steel barrier, fixing flange and flange cover.	<b>£177.00</b>



# FLAG

Mechanical saloon-type swing turnstiles



## The multi-purpose solution for controlling pedestrian flows

- Flag is the mechanical swing turnstile that you push to open, and closes automatically thanks to the spring mechanism.
- It can be used in many different environments: swimming pools, gyms, retail outlets, emergency exits, shopping centres and supermarkets.
- It is designed to aid access for disabled people.
- Flag is ideal wherever you need to control the direction in which people move.
- It is perfect if used as a service access in retail outlets and as an opening used as an emergency exit.

## Dimensions (mm)

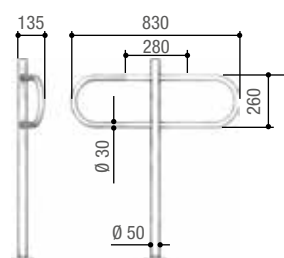
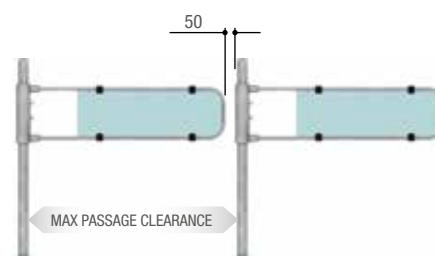
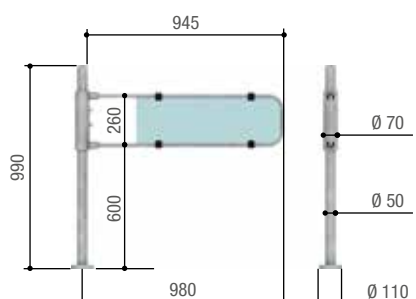

PSOPG01 - PSOPG01X



Code	Description	Price (Excl. VAT)
<b>Mechanical swing turnstiles</b>		
001 <b>PSBPCW0A</b>	Mechanical swing turnstiles with right-hand post and key lock.	<b>£340.00</b>
001 <b>PSBPCCWA</b>	Mechanical swing turnstiles with left-hand post and key lock.	<b>£340.00</b>
001 <b>PSBP00A</b>	Bidirectional mechanical swing turnstile with key lock.	<b>£344.00</b>
<b>Accessories</b>		
001 <b>PSOPG01</b>	AISI 304 steel channeller, galvanised steel fixing flange and chrome-plated plastic flange cover.	<b>£162.00</b>
001 <b>PSOPG01X</b>	AISI 304 steel channeller, fixing flange and flange cover.	<b>£177.00</b>
<b>Customised fabrication</b>		
001 <b>PSMLANT014.66</b>	Extra-charge to change the leaf length. (Min. = 500 mm - Max. = 900 mm).	<b>£93.00</b>

## NOTES

001PSMLANT01 Specify width of customised leaf.



# ACCESSORIES

## Barriers



### A comprehensive range to complete a barrier system configuration

- AISI 304 steel modular barrier system.
- Simple to assemble, these are particularly useful in combination with all types of turnstiles, both alone as channellers for pedestrian flows or to mark off areas for different types of user.

### Dimensions (mm)

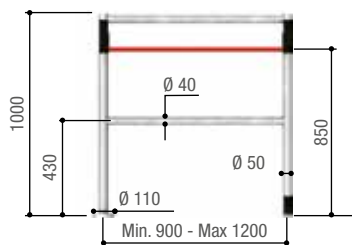
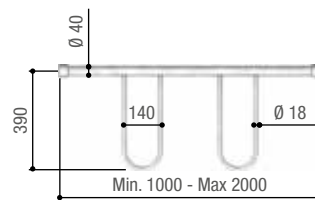
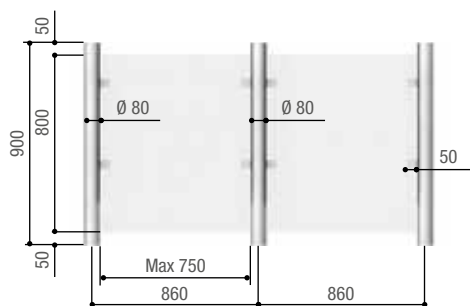
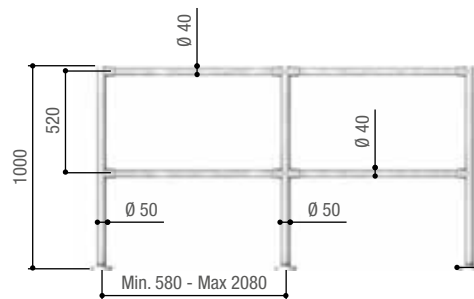
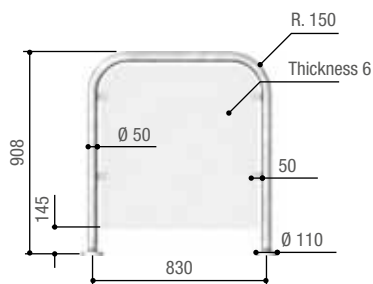

Code	Description	Price (Excl. VAT)
Post for modular barriers		
001PSTRV	Galvanised steel post with fixing flange and chrome-plated plastic flange cover without holes. H = 1,000 mm.	£61.00
001PSTRV2F	Galvanised steel post with fixing flange and chrome-plated plastic flange cover with 2 holes. H = 1,000 mm.	£76.00
001PSTRV4F90	Galvanised steel post with fixing flange and chrome-plated plastic flange cover with 2 + 2 holes at 90°. H = 1,000 mm.	£63.00
001PSTRV4F180	Galvanised steel post with fixing flange and chrome-plated plastic flange cover with 2 + 2 holes at 180°. H = 1,000 mm.	£61.00
001PSTRV6F	Galvanised steel post with fixing flange and chrome-plated plastic flange cover with 6 holes. H = 1,000 mm.	£63.00
001PSTRV8F	Galvanised steel post with fixing flange and chrome-plated plastic flange cover with 8 holes. H = 1,000 mm.	£61.00
001PSTRVX	AISI 304 steel post with fixing flange and flange cover without holes. H = 1,000 mm.	£90.00
001PSTRVX2F	AISI 304 steel post with fixing flange and flange cover with 2 holes. H = 1,000 mm.	£91.00
001PSTRVX4F90	AISI 304 steel post with fixing flange and flange cover with 2 + 2 holes at 90°. H = 1,000 mm.	£91.00
001PSTRVX4F180	AISI 304 steel post with fixing flange and flange cover with 2 + 2 holes at 180°. H = 1,000 mm.	£90.00
001PSTRVX6F	AISI 304 steel post with fixing flange and flange cover with 6 holes. H = 1,000 mm.	£91.00
001PSTRVX8F	AISI 304 steel post with fixing flange and flange cover with 8 holes. H = 1,000 mm.	£88.00

# THE COMPLETE RANGE

Code	Description	Price (Excl. VAT)
Tubes and sleeves for modular barriers		
001PSTRT050	AISI 304 steel horizontal tube. Ø 40 mm, thickness 1 mm, L = 500 mm.	£8.00
001PSTRT100	AISI 304 steel horizontal tube. Ø 40 mm, thickness 1 mm, L = 1,000 mm.	£22.00
001PSTRT150	AISI 304 steel horizontal tube. Ø 40 mm, thickness 1 mm, L = 1,500 mm.	£24.00
001PSTRT200	AISI 304 steel horizontal tube. Ø 40 mm, thickness 1 mm, L = 2.000 mm.	£36.00
001PSTRM001	N. 2 chrome-plated plastic joint sleeves complete with fixing screws.	£8.00
001PSTRM003	N. 2 AISI 304 steel joint sleeves complete with fixing screws.	£31.00
001PSTRM004	N. 2 AISI 304 steel sleeves for wall fixing, complete with fixing screws.	£23.00

## Compositions

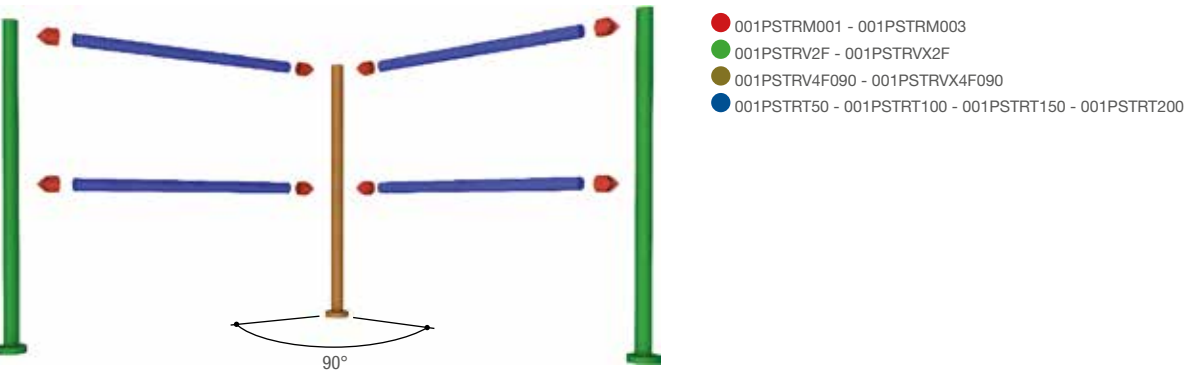
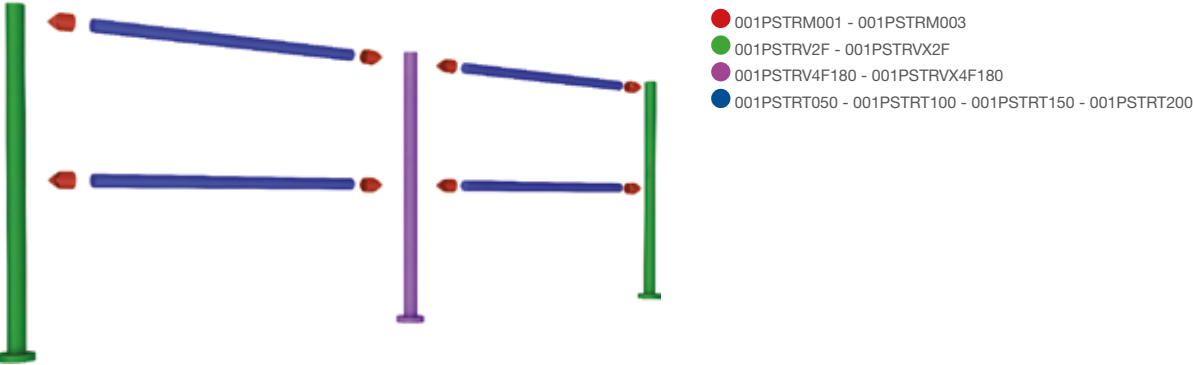

Code	Description	Price (Excl. VAT)
Monodirectional barriers for trolleys		
001 <b>PSTPC100</b>	Barrier with n. 2 arcs. L = 1,000 mm, H = 1,000 mm.	£103.00
001 <b>PSTPC150</b>	Barrier with n. 3 arcs. L = 1,500 mm, H = 1,000 mm.	£142.00
001 <b>PSTPC200</b>	Barrier with n. 4 arcs. L = 2,000 mm, H = 1,000 mm.	£172.00
Complete barriers		
001 <b>PSTRFPA</b>	AISI 304 steel barrier to fix to the floor, with 6-mm-thick polycarbonate panel. H = 900 mm.	£474.00
001 <b>PSTRFPAN</b>	AISI 304 steel barrier to fix to the floor without panel. H = 900mm.	£243.00
Barriers with antipanic bar		
001 <b>PSUS120D</b>	AISI 304 steel barrier. Right post L = 1,200 mm, H = 1,000 mm.	£468.00
001 <b>PSUS120S</b>	AISI 304 steel barrier. Left post L = 1,200 mm, H = 1,000 mm.	£468.00
001 <b>PSUS090D</b>	AISI 304 steel barrier. Right post L = 900 mm, H = 1,000 mm.	£455.00
001 <b>PSUS090S</b>	AISI 304 steel barrier. Left post L = 900 mm, H = 1,000 mm.	£455.00



# THE COMPLETE RANGE

Code	Description	Price (Excl. VAT)
Modular barriers		
001PSTRV80	AISI 304 post without clamps. H = 900 mm, Ø 80 mm.	£132.00
001PSTRV802F	AISI 304 post with 2 clamps. H = 900 mm, Ø 80 mm.	£180.00
001PSTRV804F090	AISI 304 post with 2 + 2 clamps at 90°. H = 900 mm, Ø 80 mm.	£231.00
001PSTRV804F180	AISI 304 post with 2 + 2 clamps at 180°. H = 900 mm, Ø 80 mm.	£244.00
001PSTRV806F	AISI 304 post with 6 clamps. H = 900 mm, Ø 80 mm.	£279.00
001PSTRV808F	AISI 304 post with 8 clamps. H = 900 mm, Ø 80 mm.	£332.00
001PSTRSFPL60875	Transparent polycarbonate panel. Thickness: 6 mm. L = 750 mm, H = 800 mm.	£136.00
Customised fabrications		
001PSMTP01	Extra-charge to change the width of the polycarbonate panel.	£39.00

## NOTES

001PSMTP01 Specify the customised width of the panel which must not exceed 750 mm (standard size).

## Compositions

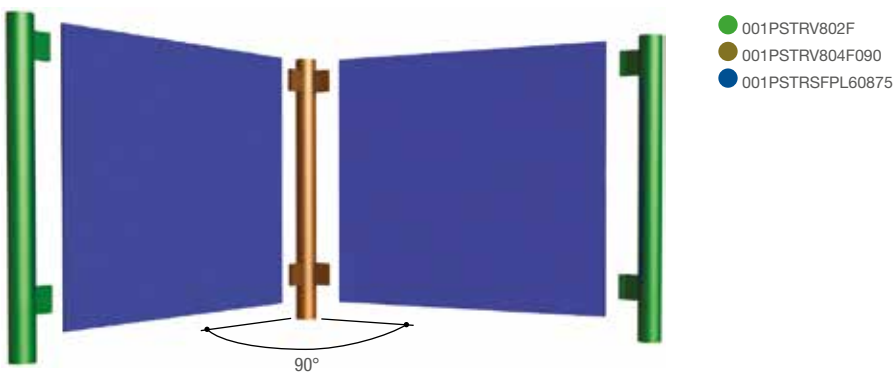
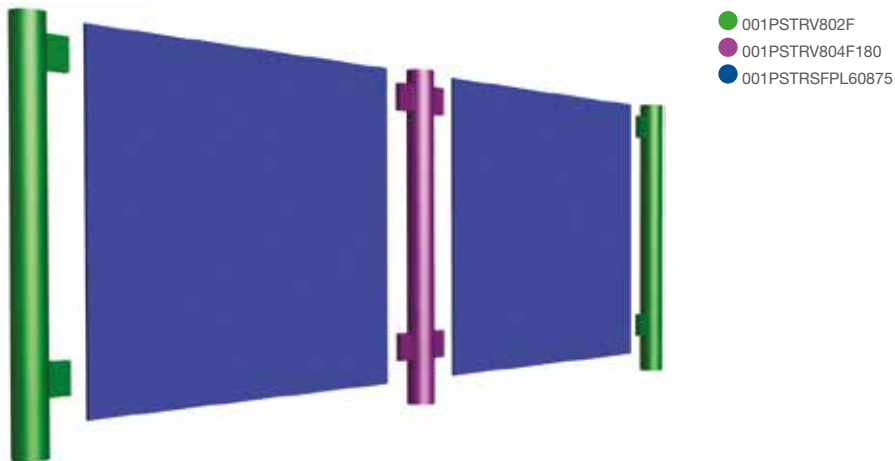



## TRAINING

# INVESTING IN YOUR STAFF. BUILDING YOUR BUSINESS

Visit [www.camebpttraining.com](http://www.camebpttraining.com) to book yourself or a member of your team on one of our industry leading professional training courses

Visit [camebpttraining.com](http://camebpttraining.com)

**CAME** 





# GENERAL CONDITIONS OF SALE

## CAME BPT UK LTD (“THE SELLER”)

The Buyer's attention is drawn in particular to the provisions of clause 10.

### 1. INTERPRETATION

1.1 Definitions. In these Conditions, the following definitions apply:

- Additional Charges: any additional charges arising under the Contract payable by the Buyer in addition to the price for the Goods and "Additional Charge" shall mean any one of the Additional Charges.
- Buyer: the person firm or company who buys or agrees to buy the Goods from the Seller.
- Conditions: these terms and conditions of sale.
- Contract: the contract between the Seller and the Buyer for the sale and purchase of Goods in accordance with these Conditions.
- Delivery Date: the date specified by the Seller when the Goods are to be delivered or other such date as may be agreed by the parties in writing;
- Delivery Location: the location set out in the Order or such other location as the parties may agree in writing, or where no such location is specified, the Buyer's premises detailed on the quotation given by the Seller to the Buyer in respect of the Goods.
- Force Majeure Event: as defined in clause 11.1.
- Goods: all goods (or any part thereof) set out in the Order.
- Group: in relation to a company, that company, any subsidiary or holding company (as defined in section 1159 of the Companies Act 2006) of that company, and any subsidiary of a holding company of that company.
- Order: the Buyer's order for the Goods, as set out in the Buyer's purchase order form, the Buyer's written acceptance of the Seller's quotation, or overleaf, as the case maybe.
- Seller: CAME BPT UK Limited, registered in England and Wales with company number 03267714, whose registered office is Unit 1B, Willow Farm Business Park, Castle Donington, Derby, DE74 2US.
- Wasted Time Rate: the charge for wasted time at the Seller's standard rate for wasted time of £1 (one pound) per minute up to and including 30 (thirty) minutes and thereafter at a charge of £2 (two pounds) per minute, or such other charge as notified to the Buyer from time to time.
- 1.2 Construction. In these Conditions, the following rules apply:
- (a) A person includes a natural person, corporate or unincorporated body (whether or not having separate legal personality).
- (b) A reference to a party includes its personal representatives, successors or permitted assigns.
- (c) A reference to a statute or statutory provision is a reference to such statute or provision as amended or re-enacted. A reference to a statute or statutory provision includes any subordinate legislation made under that statute or statutory provision, as amended or re-enacted.
- (d) Any phrase introduced by the terms including, include, in particular or any similar expression shall be construed as illustrative and shall not limit the sense of the words preceding those terms.
- (e) A reference to writing or written includes faxes and e-mails.

### 2. BASIS OF CONTRACT

- 2.1 These Conditions shall apply to the sale by the Seller of all Goods purchased by the Buyer and these Conditions shall govern the Contract to the exclusion of any other terms and conditions introduced or submitted by the Buyer.
- 2.2 The Order constitutes an offer by the Buyer to purchase the Goods in accordance with these Conditions. The Buyer is responsible for ensuring that the terms of the Order and any applicable specification of the Goods are complete and accurate.
- 2.3 The Order shall only be deemed to be accepted when the Seller acknowledges the Order in writing and not before, at which point the Contract shall come into existence.
- 2.4 Any tenders or quotations will not constitute an offer. Any tenders or quotations submitted to the Buyer shall remain valid for the period stated therein, but if no period is specified such tenders and quotations shall be valid for 30 days from the date thereof. All tenders and quotations shall be subject to these Conditions.
- 2.5 Any typographical, clerical or other error or omission in any sales literature, quotation, pricelist, acceptance of offer, invoice or other documentation or information issued by the Seller shall be subject to correction without any liability on the part of the Seller.
- 2.6 The Seller's employees or agents are not authorised to make any representations concerning the Goods unless confirmed by an authorised director of the Seller in writing. In entering into the Contract the Buyer acknowledges that it does not rely on any such representations which are not so confirmed, save that nothing in these Conditions shall exclude the Sellers liability for fraudulent misrepresentation.
- 2.7 No Order which has been accepted by the Seller may be cancelled by the Buyer except with the agreement in writing of the Seller and on terms that the Buyer shall indemnify the Seller in full against all loss (including loss of profit), costs (including the cost of all labour and materials used), damages, charges and expenses incurred by the Seller as a result of cancellation.

### 3. GOODS

- 3.1 The Goods are described in the Seller's catalogue as modified by any applicable specification.
- 3.2 Unless the Seller agrees otherwise, only the specifications referred to in the quotation shall form part of the Contract.
- 3.3 The Seller reserves the right subject to giving prior written notice to the Buyer to modify the said specifications where the Goods cannot in the opinion of the Seller be manufactured according to the said specifications and the Buyer agrees to accept the Goods as manufactured according to the specifications so modified in satisfaction of the Seller's obligations as to manufacture of the Goods under the Contract.
- 3.4 To the extent that the Goods are to be manufactured in accordance with a specification supplied by the Buyer, the Buyer shall indemnify the Seller against all liabilities, costs, expenses, damages and losses (including any direct, indirect or consequential losses, loss of profit, loss of reputation and all interest, penalties and legal and other reasonable professional costs and expenses) suffered or incurred by the Seller in connection with any claim made against the Seller for actual or alleged infringement of a third party's intellectual property rights arising out of or in connection with the Seller's use of such specification. This clause 3.2 shall survive termination of the Contract.
- 3.5 The Seller reserves the right to make any changes to the Goods:
- (a) which are required so that the Goods conform with any applicable statutory or EU requirement; or
- (b) where such changes to the Goods do not materially affect the quality or performance of the Goods.

### 4. SAFETY

- 4.1 Any Goods supplied by the Seller shall be handled correctly by the Buyer and in accordance with any of the Seller's instructions as notified to the Buyer from time to time. The Buyer must ensure that all appropriate safety precautions are taken and that its staff is aware of and comply with all storage and usage instructions.

### 5. DELIVERY

- 5.1 Unless otherwise agreed by the Seller in writing, the Seller will deliver the Goods to the Delivery Location.
- 5.2 The Seller will reasonably endeavour to deliver the Goods on the Delivery Date, but the time of delivery or performance shall not be of the essence. The Seller shall not be liable for any delay in delivery of the Goods that is caused by a Force Majeure Event or the Buyer's failure to provide the Seller with adequate delivery instructions or any other instructions that are relevant to the supply of the Goods.
- 5.3 If the Seller fails to deliver the Goods (or any instalment thereof) the Seller's liability shall be limited to the excess (if any) of the cost to the Buyer (in the cheapest available market) of similar goods to replace those not delivered over the Price of the Goods. The Seller shall have no liability for any failure to deliver the Goods to the extent that such failure is caused by a Force Majeure Event, the Buyer's fault, or the Buyer's failure to provide the Seller with adequate instructions in relation to delivery or otherwise.
- 5.4 The Buyer shall provide the Seller with clear delivery instructions and accept delivery on the Delivery Date and at the Delivery Location. Upon delivery the Buyer shall sign a delivery note which will be conclusive evidence that delivery of the Goods has been made.
- 5.5 Unless the Seller agrees otherwise in writing, the Seller shall unload the Goods. The Buyer shall ensure that at least one representative is available to assist the Seller during the unloading of the Goods. Other than by reason of the Seller's fault, the Buyer shall be charged, as an Additional Charge, for wasted time at the Wasted Time Rate and any other expenses incurred by the Seller for:
- (a) any delay caused by the Buyer's inability or unwillingness to accept delivery of, or to collect, the Goods; and/or
- (b) each repeat delivery where the Seller or Seller's carrier leaves the Delivery Location and subsequently returns to the Delivery Location with the Goods.
- 5.6 If the Buyer fails to accept delivery of the Goods within three Business Days of the Seller notifying the Buyer that the Goods are ready, then, except where such failure or delay is caused by a Force Majeure Event or the Seller's failure to comply with its obligations under the Contract:
- (a) delivery of the Goods shall be deemed to have been completed at 9.00am on the third working day after the day on which the Seller notified the Buyer that the Goods were ready; and
- (b) the Seller will store the Goods until delivery takes place, and charge the Buyer for all related costs and expenses (including insurance).
- 5.7 If the Buyer has not accepted delivery of the Goods within 10 working days from day after the Seller notified the Buyer that the Goods were ready for delivery, the Seller may resell or otherwise dispose of part or all of the Goods and, after deducting reasonable storage and selling costs, account to the Buyer for any excess over the price of the Goods or charge the Buyer for any shortfall below the price of the Goods.
- 5.8 The Seller shall have the right to deliver any Goods ordered in instalments. Failure by the Seller to deliver any one or more of the instalments in accordance with these Conditions or any claim by the Buyer in respect of the Goods delivered in any one or more instalments shall not entitle the Buyer either to treat the Contract as a whole as repudiated or to reject or refuse to take delivery of any of the Goods delivered in any other instalment.

### 6. RISK AND TITLE

- 6.1 Risk in the Goods shall pass to the Buyer at the time of delivery, or if the Buyer wrongfully fails to take delivery, the time when delivery is deemed to have taken place in accordance with clause 5.6(a).
- 6.2 Title to the Goods shall not pass to the Buyer until the earlier of:
- (a) the Seller receives payment in full (in cash or cleared funds) for the Goods and any other goods that the Seller has supplied to the Buyer in respect of which payment has become due, in which case title to the Goods shall pass at the time of payment of all such sums; or
- (b) the Buyer resells the Goods, in which case title to the Goods shall pass to the Buyer at the time specified in clause 6.4.
- 6.3 Until title to the Goods has passed to the Buyer, the Buyer shall:
- (a) store the Goods separately from all other goods held by the Buyer so that they remain readily identifiable as the Seller's property;
- (b) not remove, deface or obscure any identifying mark or packaging on or relating to the Goods;
- (c) maintain the Goods in satisfactory condition and keep them insured against all risks for their full price from the date of delivery;
- (d) notify the Seller immediately if it becomes subject to any of the events listed in clause 13.1;
- (e) give the Seller such information relating to the Goods as the Seller may require from time to time; and
- (f) not pledge or in any way charge by way of security for any indebtedness any of the Goods.
- 6.4 Subject to clause 6.5, the Buyer may resell or use the Goods in the ordinary course of its business (but not otherwise) before the Seller receives payment for the Goods. However, if the Buyer resells the Goods before that time:
- (a) it does so as principal and not as the Seller's agent; and
- (b) title to the Goods shall pass from the Seller to the Buyer immediately before the time at which resale by the Buyer occurs.
- 6.5 If before title to the Goods passes to the Buyer the Buyer becomes subject to any of the events listed in clause 13.1, then, without limiting any other right or remedy the Seller may have:
- (a) the Buyer's right to resell the Goods or use them in the ordinary course of its business ceases immediately; and
- (b) the Seller may at any time:
- (i) require the Buyer to deliver up all Goods in its possession which have not been resold, or irrevocably incorporated into another product; and
- (ii) if the Buyer fails to do so promptly, enter any premises of the Buyer or of any third party where the Goods are stored in order to recover them.



## 7. PRICE

- 7.1 The price for the Goods shall be the price specified by the Seller in the quotation or, if no price is quoted, the price set out in the Seller's published price list in force as at the date of delivery.
- 7.2 Unless otherwise agreed in writing, the price of the Goods is exclusive of the costs and charges of packaging, insurance and transport of the Goods, which shall be invoiced to the Buyer as an Additional Charge.
- 7.3 The price of the Goods and any Additional Charges are exclusive of amounts in respect of value added tax (VAT). The Buyer shall, on receipt of a valid VAT invoice from the Seller, pay to the Seller such additional amounts in respect of VAT as are chargeable on the supply of the Goods.
- 7.4 The Seller may, by giving notice to the Buyer at any time before delivery, increase the price of the Goods to reflect any increase in the cost of the Goods that is due to:
- (a) any factor beyond the Seller's control (including foreign exchange fluctuations, increases in taxes and duties, and increases in labour, materials and other manufacturing costs);
  - (b) any request by the Buyer to change the delivery date(s), quantities or types of Goods ordered, or the Specification; or
  - (c) any delay caused by any instructions of the Buyer or failure of the Buyer to give the Seller adequate or accurate information or instructions.

## 8. PAYMENT

- 8.1 The Seller shall be entitled to invoice the Buyer for price of the Goods and any Additional Charges on or at any time before dispatch of the Goods or any instalment thereof. In the event that any Additional Charges arise following the issue by the Seller of the invoice, the Seller shall be entitled to invoice the Buyer as and when the Additional Charges arise.
- 8.2 Unless otherwise agreed in writing, the Buyer shall pay the invoice in full and in cleared funds by the date specified in the invoice or where no date or time frame is specified within 30 calendar days of the date of the invoice. Payment shall be made to the bank account nominated in writing by the Seller. Time of payment is of the essence.
- 8.3 The Buyer shall make payment for the price of the Goods in Sterling (euros) unless agreed otherwise in writing. Any payment received by the Seller in any other currency will not be deemed to be payment for the Goods in question. Where the Buyer makes payment for the Goods by cheque the Seller reserves the right to charge a surcharge of £10.00 in the event that any cheque rendered in payment of the Seller's invoices initially refused.
- 8.4 If the Buyer fails to make payment due to the Seller under the Contract by the due date for payment then, without prejudice to any other right or remedy available to the Seller:
- (a) all invoices issued to the Buyer by the Seller in respect of any Goods sold or supplied pursuant to the Contract or any goods sold or supplied pursuant to any other contract shall immediately fall due for payment;
  - (b) any credit, settlement terms, supply of goods or discount rates offered or extended by the Seller to the Buyer in respect of the same shall be cancelled immediately;
  - (c) the Buyer shall pay interest on the overdue amount at the rate of 10% per annum above Seller's bank's base rate from time to time. Such interest shall accrue on a daily basis from the due date until actual payment of the overdue amount, whether before or after judgment. The Buyer shall pay the interest together with the overdue amount; and
  - (d) the Seller shall be entitled to suspend any further deliveries of any Goods or goods agreed to be sold by the Seller to the Buyer or any instalment thereof (being the subject of the Contract or any other contract).
- 8.5 The Buyer shall pay all amounts due under the Contract in full without any set-off, counterclaim, deduction or withholding (except for any deduction or withholding required by law). The Seller may at any time, without limiting any other rights or remedies it may have, set off any amount owing to it by the Buyer against any amount payable by the Seller to the Buyer.

## 9. WARRANTY

- 9.1 The Seller warrants that:
- (a) the Goods will correspond with the Seller's specification for them on delivery;
  - (b) the Goods (except those wear items that are listed in the Seller's guide entitled "Operations Guide Relating to the Goods" as notified to the Buyer and as amended from time to time) manufactured by the Seller or its Group, will be free from material defects for 3 years from the Delivery Date; and
  - (c) where the seller is supplying goods from other manufacturers; their standard recommended warranty will apply.
- 9.2 Subject to clause 9.3, if:
- (a) the Buyer gives notice in writing to the Seller immediately on discovery but in any event within 14 days of discovery that some or all of the Goods do not comply with the warranty set out in clause 9.1;
  - (b) the Seller is given a reasonable opportunity of examining such Goods; and
  - (c) the Buyer (if asked to do so by the Seller) returns such Goods to the Seller's place of business at the Buyer's cost, the Seller shall, at its option, repair or replace the defective Goods, or refund the price of the defective Goods in full.
- 9.3 The Seller shall not be liable for Goods' failure to comply with the warranty set out in clause 9.1 in any of the following events:
- (a) the Buyer makes any further use of such Goods after giving notice in accordance with clause 9.2;
  - (b) the defect arises because the Buyer failed to follow the Seller's oral or written instructions as to the storage, commissioning, installation, use and maintenance of the Goods or (if there are none) good trade practice regarding the same;
  - (c) the defect arises as a result of the Seller following any drawing, design or Specification supplied by the Buyer;
  - (d) the Buyer alters or repairs such Goods without the written consent of the Seller;
  - (e) the defect arises as a result of fair wear and tear, wilful damage, negligence, or abnormal storage or working conditions; or
  - (f) the Goods differ from their description specification as a result of changes made to ensure they comply with applicable statutory or regulatory requirements.
- 9.4 Except as provided in this clause 9, the Seller shall have no liability to the Buyer in respect of the Goods' failure to comply with the warranty set out in clause 9.
- 9.5 The terms implied by sections 13 to 15 of the Sale of Goods Act 1979 are, to the fullest extent permitted by law, excluded from the Contract.
- 9.6 These Conditions shall apply to any repaired or replacement Goods supplied by the Seller.

## 10. LIABILITY

- 10.1 Nothing in these Conditions shall limit or exclude the Seller's liability for:
- (a) death or personal injury caused by its negligence, or the negligence of its employees, agents or subcontractors (as applicable);
  - (b) fraud or fraudulent misrepresentation;
  - (c) breach of the terms implied by section 12 of the Sale of Goods Act 1979;
  - (d) defective products under the Consumer Protection Act 1987; or
  - (e) any matter in respect of which it would be unlawful for the Seller to exclude or restrict liability.

## 10.2 Subject to clause 10.1:

- (a) the Seller shall under no circumstances whatever be liable to the Buyer, whether in contract, tort (including negligence), breach of statutory duty, or otherwise, for any loss of profit, goodwill or any indirect or consequential loss arising under or in connection with the Contract; and
- (b) the Seller's total liability to the Buyer in respect of all other losses arising under or in connection with the Contract, whether in contract, tort (including negligence), breach of statutory duty, or otherwise, shall in no circumstances exceed 100% of price of the Goods.

## 11. FORCE MAJEURE

- 11.1 The Seller shall not be liable to the Buyer nor be deemed to be in breach of Contract by reason of any delay in performing, or any failure to perform, any of the Seller's obligations in relation to the Contract if the delay or failure was due to a Force Majeure Event. The following shall (without limitation) be regarded as Force Majeure Event:
- (a) act of God, explosion, flood, tempest, fire or accident;
  - (b) war or threat of war, sabotage, insurrection, terrorism, civil disturbance or requisition;
  - (c) acts, restrictions, regulations, bye-laws, prohibitions or measures of any kind on the part of any governmental, parliamentary or local authority;
  - (d) import or export regulations or embargoes;
  - (e) strikes, lock-outs or other industrial actions or trade disputes (whether involving employees of the Seller or of a third party);
  - (f) difficulties in obtaining raw materials, labour, fuel, parts or machinery; and
  - (g) power failure or breakdown in machinery.

## 12. INTELLECTUAL PROPERTY

- 12.1 All specifications, drawings, designs and technical description, and all documents and information and "know-how" whatsoever supplied by the Seller to the Buyer is as between the Seller and the Buyer the Seller's intellectual property and shall at all times be treated by the Buyer as confidential and shall not without the prior written consent of the Seller be used by the Buyer except for the purposes of the Contract.
- 12.2 The Buyer will indemnify the Seller against all actions claims demands costs charges, penalties, royalties and expenses arising directly or indirectly or incurred by reason of any infringement or alleged infringement of or any right attributable to any letters patent, registered design trade mark, trade name, copyright or proprietary right arising from the use of any instructions, specifications or designs whether express or implied supplied by the Buyer to the Seller.

## 13. INSOLVENCY OF BUYER

- 13.1 This Condition applies if:
- (a) the Buyer makes any voluntary arrangement with its creditors or (being an individual or firm) becomes bankrupt or (being a company) becomes subject to an administration order or goes into liquidation (otherwise than for the purposes of amalgamation or reconstruction); or
  - (b) an encumbrancer takes possession or a receiver is appointed, of any of the property or assets of the Buyer; or
  - (c) the Buyer ceases, or threatens to cease, to carry on business; or
  - (d) the Seller reasonably apprehends that any of the events mentioned above is about to occur in relation to the Buyer and notifies the Buyer accordingly.
- 13.2 If this Condition applies then, without prejudice to any other right or remedy available to the Seller, the Seller shall be entitled to terminate the Contract with immediate effect by giving written notice to the Buyer and/or suspend any further deliveries under the Contract without any liability to the Buyer, and if the Goods have been delivered but not paid for, all of the Seller's outstanding invoices to the Buyer become immediately due and payable notwithstanding any previous agreement or arrangement to the contrary.
- 13.3 Termination of the Contract, however arising, shall not affect any of the parties' rights, remedies, obligations and liabilities that have accrued as at termination.

## 14. GENERAL

- 14.1 Notices. Any notice required or permitted to be given by either party to the other under these Conditions shall be in writing addressed to that other party at his registered office or principal place of business or such other address as may at the relevant time have been notified pursuant to this provision to the party giving the notice.
- 14.2 Severance. If any provision of these Conditions is held by any competent authority to be invalid or unenforceable in whole or in part the validity of the other provisions of these Conditions shall remain in full force and effect.
- 14.3 Waiver. No waiver by the Seller of any breach of the Contract by the Buyer shall be considered as a waiver of any subsequent breach of the same or any other provision.
- 14.4 Third party rights. A person who is not a party to the Contract shall not have any rights to enforce its terms.
- 14.5 Variation. No variation of these Conditions may be given by any of the Seller's employees unless confirmed in writing by an authorised director of the Seller and no collateral or supplemental contract may be made or construed unless confirmed in writing by an authorised director of the Seller on the Seller's official stationery.
- 14.6 Entire Agreement. The Buyer acknowledges that it has not relied on any statement, promise, representation, assurance or warranty made or given by or on behalf of the Seller which is not set out in the Contract.
- 14.7 Governing law and jurisdiction. The Contract shall be governed by the laws of England, and the Buyer agrees to submit to the non-exclusive jurisdiction of the English courts.

## 15. SPECIFICATIONS AND INSTRUCTIONS

- 15.1 Unless the Seller agrees otherwise, only the specifications referred to in the quotation shall form part of the Contract.
- 15.2 The Seller reserves the right subject to giving prior written notice to the Buyer to modify the said specifications where the Goods cannot in the opinion of the Seller be manufactured according to the said specifications and the Buyer agrees to accept the Goods as manufactured according to the specifications so modified in satisfaction of the Sellers obligations as to manufacture of the Goods under the contracts.
- 15.3 App Based Goods – the Buyer shall ensure that prior to supplying any app based goods to any customer it shall include within its customer terms and conditions for supply of the App based Goods a requirement for the customer to have read, understood and agreed to the app terms and conditions for the Goods prior to completion of purchase of the Goods. Where such Goods are supplied or installed by a third party for and/or on behalf of the Buyer the Buyer shall ensure that such installer also complies with this clause 10.3 by including this provision in its contract with the installer.

**CAME** 



**CAME BPT - North**

Unit 1B  
Sills Road  
Willow Farm Business Park  
Castle Donington  
DE74 2US  
**Tel:** 0115 921 0430

**CAME BPT - South**

Liberta House  
Maxted Road  
Maylands Ind. Est.  
Hemel Hempstead  
Herts  
HP2 7DX  
**Tel:** 01442 230 800

**CAME BPT - Ireland**

Unit 9  
The Westway Centre  
Ballymount  
Dublin 12  
**Tel:** +353 (0)1 450 7442



THE DATA AND INFORMATION SHOWN IN THIS CATALOGUE ARE SUBJECT TO CHANGE WITHOUT OBLIGATION TO GIVE PRIOR NOTICE BY CAME S.P.A, E&OE

**CAME S.P.A.**

Via Martiri della Libertà, 15  
31030 Dosson di Casier  
Treviso - ITALY

Came cancelli automatici S.p.A.  
is certified for Quality and Environment  
**UNI EN ISO 9001**  
**UNI EN ISO 14001**  
**BS OHSAS 18001**